

**Which labeller is
better for you?**



Via Luigi Einaudi, 10 - 20832 Desio (MB) Italy - Tel. +39 0362 1400201 - Fax +39 0362 1400299 - info@epackagingsrl.com - www.epackagingsrl.com



EPK S - EPK B

All in one
STEP OR BRUSHLESS MOTOR



LABELLING HEADS

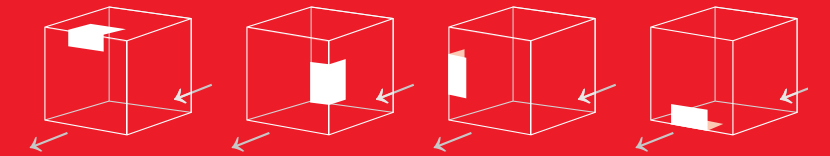
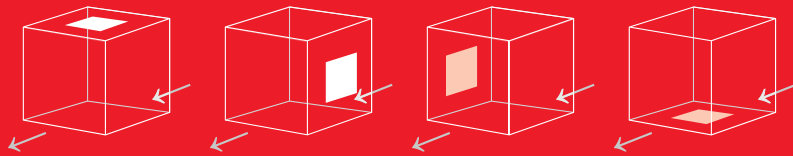

LABELLING HEADS

high speed application

Automatic self-adhesive label applicators to be installed on production lines, perfect to the apply on upper, side or bottom side. Using brushless motors ensures high reliability and precision. All running parameters can be set by a touch screen control unit and 50 recipes can be saved on it.

Build in control panel, multicolor and multi languages UL/CSA ready ready for HP printer, TTO printer, Printing engine integration, with the proper optional. Available in Step motors till 35 m/min Series S or brushless motor till 70m/min Series B. Industry 4.0 remote control and predictive maintenance.

Applicatori automatici di etichette auto-adesive da abbinare a linee di produzioni, ideali per l'applicazione di etichette sulla superficie superiore, inferiore o laterale. L'utilizzo di motori brushless garantisce alta affidabilità e precisione. Una centralina con controlli touch permette di settare tutti i parametri di funzionamento e di memorizzare 50 ricette

Canale di controllo incorporato, multicolore e multilingue Disponibile con motori Step fino a 35 m/min Serie S o motori brushless fino a 70 m/min Serie B. Controllo remoto e manutenzione preventiva Industry 4.0.



SCREENSAVER

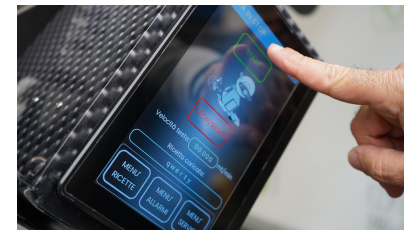

TOUCHSCREEN OPERATION SYSTEM

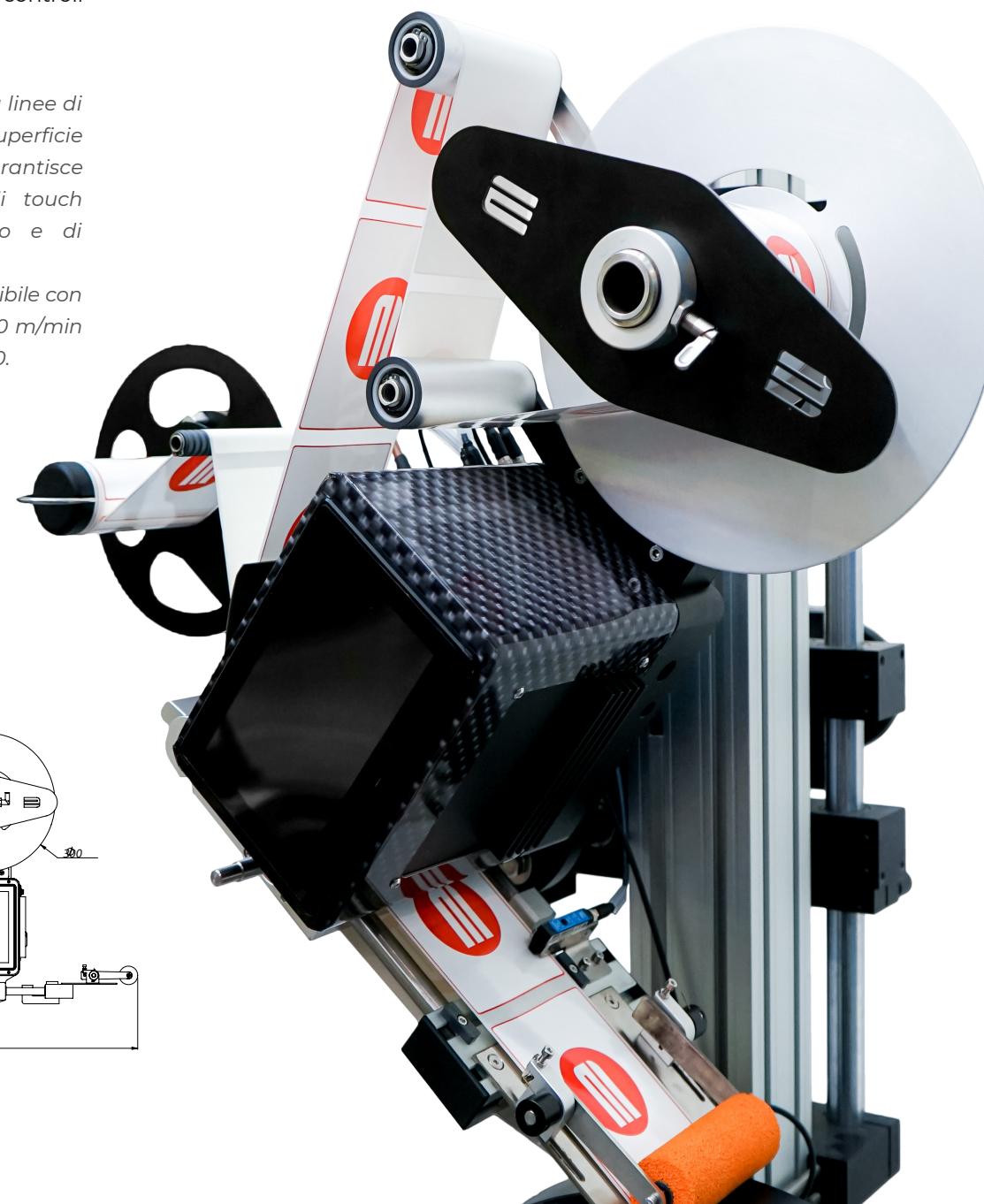

Dimensions

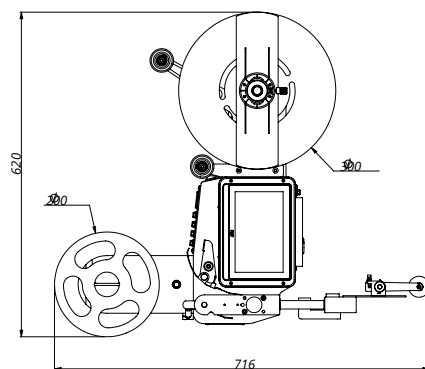

EPK S

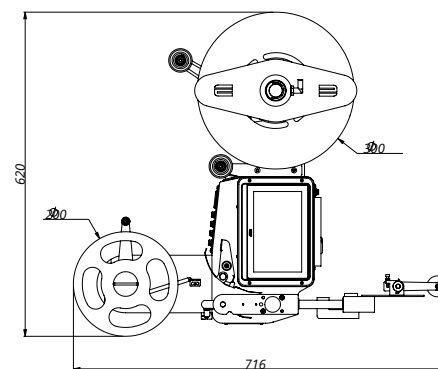

EPK B

EPK series

MODEL	LABEL WIDTH
EPK120	120 mm
EPK160	160 mm
EPK220	220 mm
EPK260	260 mm
<hr/>	
LABELS LONG MAX	500 mm
INTERNAL CORE DIAMETER	38 mm (76 mm with adaptor)
LABELS ROLL DIAMETER	300 mm
POWER SUPPLY	220 or 110 V 50/60 Hz
WATT	200 W
SPEED <small>(label dimension and roll weight can modify it)</small>	EPK S 35 - m/min EPK B 70 - m/min

Optionals

FULL STAND
Colonna con movimento

SUPPORT FOR HP PRINTING
Supporto per stampa HP

SUPPORT FOR TTO PRINTING
Supporto per stampante TTO

SUPPORT FOR PRINTING ENGINE
Supporto per motore di stampa

ENCODER
Encoder

PREEND OF LABEL
Prefine bobine

ULTRASONIC LABEL SENSOR*
*Fotocellula ultrasuoni**
*For clear label / Per etichette trasparenti

CASTER
Ruote

LAMP ALARM
Allarme visivo